

eMPF™ Registration



**Web Portal
User Guide**



Preface

The **eMPF™ Platform** is a centralized and integrated electronic platform that aims to standardize, streamline and automate the administration processes of different MPF schemes, with a view to enhancing operational efficiency, reducing administration costs and improving user experience in managing their MPF account(s).

This user guide provides step-by-step instructions on how a scheme member registers for **eMPF** on the **eMPF Web Portal**. Upon successful registration, users can access the electronic services offered by the **eMPF Platform**, including MPF account management and submission of MPF scheme instructions. All screenshots are for illustration purposes only. The actual design of the portal interface may be different.

For any enquiries regarding the **eMPF Platform**, please contact us through the following channels:

eMPF Customer Service Hotline	183 2622
Email	enquiry@support.empf.org.hk
eMPF Service Centre	Hong Kong Island Unit 601B, 6/F, Dah Sing Financial Centre, No. 248 Queen's Road East, Wanchai, Hong Kong
	Kowloon Suites 1204-6, 12/F, Chinachem Golden Plaza, No. 77 Mody Road, Tsim Sha Tsui East, Kowloon
	New Territories Suite 1802A, 18/F, Tower 2, Nina Tower, No. 8 Yeung Uk Road, Tsuen Wan, New Territories
	Opening Hours Monday to Friday : 9:00 a.m. to 6:00 p.m. Saturday : 9:00 a.m. to 1:00 p.m. Closed on Sunday and Public Holiday

Version: 1.2

Date : 30 Apr, 2026

eMPF™ Registration

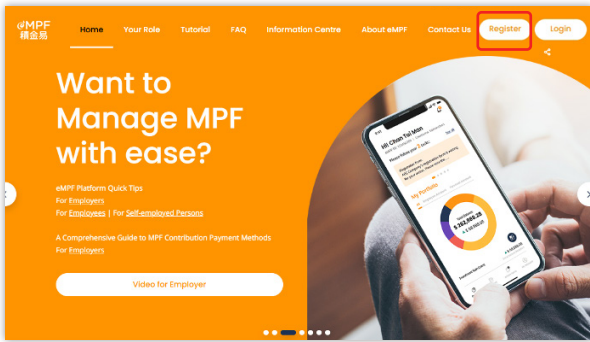

1 Visit eMPF Website www.empf.org.hk

2 Click **Register** on the top right-hand corner of the menu bar.

3 Select **"Scheme Member"**.

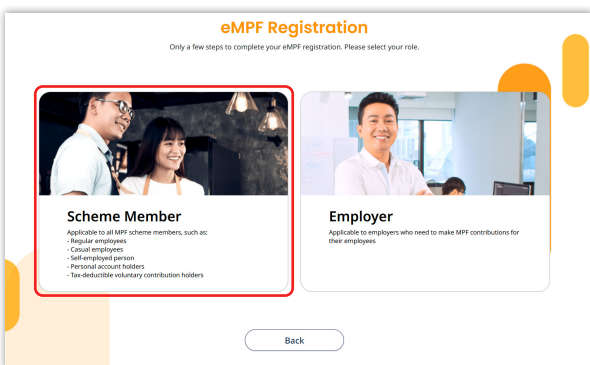

4 Read the notice and tap **Continue**.

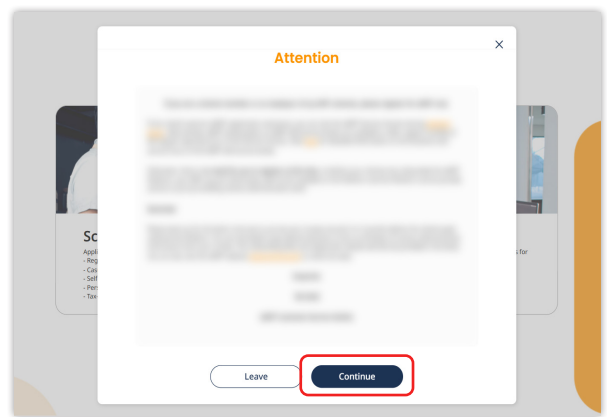

5 Read the instructions and click **Register**.

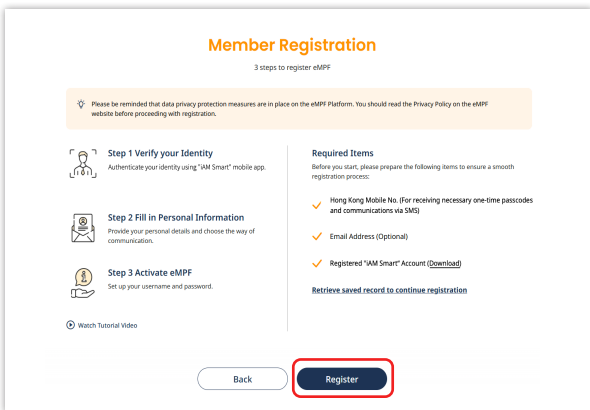

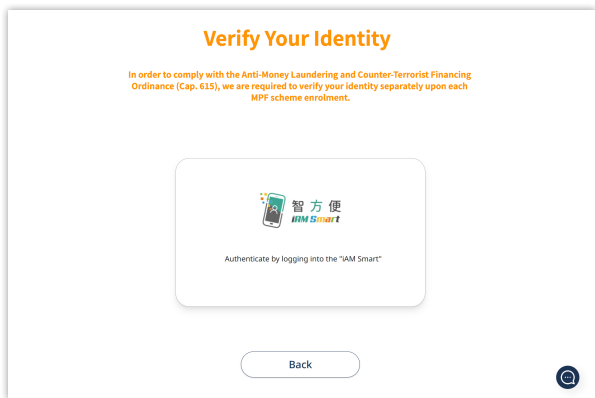

6 Please verify with **“iAM Smart”**.



Tips: Please have your smartphone ready.

Verify with “iAM Smart”

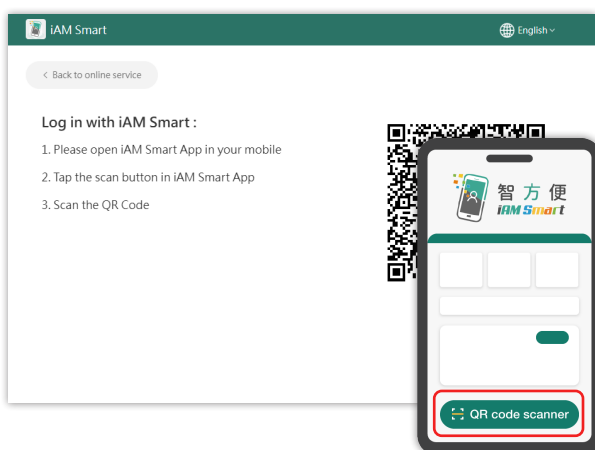

1 Download the **“iAM Smart”** mobile app to your smartphone and register as an **“iAM Smart”** user.



2 Log in to **“iAM Smart”** and tap **QR code scanner**. Scan the QR code shown on the webpage and perform the subsequent steps as indicated on your **“iAM Smart”** mobile app.

▶ Continue the Registration via eMPF Web Portal

7 After you complete the authentication process via “iAM Smart”, some of your personal information will be pre-filled automatically. Please review if the pre-filled information is correct and fill in the remaining information including Contact Information, Address and more. Then, click **Next**.



Tips: Please remember to verify your **email address** and/or **mobile phone number** by clicking **Verify** next to these 2 fields. You will receive a one-time passcode through email and/or SMS respectively, simply enter the verification code to finish the verification.

8 Review the information and click **Submit**.

Confirmation

Personal Details

Title Mr	
Surname (English) Chan	Given Name (English) Tai Man
Surname (Chinese) 陳	Given Name (Chinese) 太文
ID Document Type HKID	ID No. L8670199
Date of Birth (DD/MM/YYYY) 11/11/1980	Gender Male

Contact Information

Email Address
chantaiman@abc.com

Mobile No.
+852 99123456

[Edit](#)

Address

Residential Address

Country / Region Hong Kong, China	City
Flat / Shop / Unit / Suite / Room / Others Room 3	Floor (e.g. please input "12/F") 2/F
Block / Tower / House / Others Block 1	Building ABC Building
Street (street no. and street name) 123 K Road	District Kwun Tong
Postal Code	

Correspondence Address

Country / Region Hong Kong, China	City
Flat / Shop / Unit / Suite / Room / Others Room 3	Floor (e.g. please input "12/F") 2/F
Block / Tower / House / Others Block 1	Building ABC Building
Street (street no. and street name) 123 K Road	District Kwun Tong
Postal Code	

[Edit](#)

Way of Communication

Preferred Channel of Communication SMS	Preferred Language of Communication English
--	---

Consent on Direct Marketing of eMPF Platform: You agree to provide your consent for your personal data to be used for direct marketing purposes in accordance with the "Direct Marketing" section of the [Personal Information Collection Statement \(eMPF.org.hk/pica/en\)](#) of eMPF Platform Company Limited. Your indication herein will replace any indication of choice you may have previously provided to eMPF Platform Company Limited in relation to "Direct Marketing".

Yes

[Edit](#)

[Back](#) [Submit](#)

9 Read the Terms and Conditions and click **Accept**.

Terms and Conditions

By clicking the "Accept" button below, you confirm that:
1/ the information given in this application is correct and complete;
2/ you understood once your application is submitted, it could not be withdrawn; and
3/ you have read and agree to be bound by the Terms & Conditions below.

Decline
Accept

10 You will be given an **eMPF ID** immediately. Please click **Activate Now**.



Activate your eMPF

🔒 **eMPF ID: 20000895076**

Your eMPF ID is a unique ID for you to access the eMPF Platform for a lifetime. From now on, you can manage all of your MPF accounts on the eMPF Platform. You have registered your eMPF successfully, please activate now.

Note: In compliance with the requirements under the Anti-Money Laundering and Counter-Terrorist Financing Ordinance (Cap. 615), we are required to authenticate your identity each time you log into an MPF scheme.

Activate Now

11 Create your **eMPF username and password**, then click **Next** to start to use the **eMPF Platform**.

Create Username and Password

eMPF ID: 20000895076

Username Requirement

- 8 - 50 characters with at least 1 alphabet, underscore (_) and full stop (.) can be used.

Password Requirements

- At least 10 characters
- At least 1 upper case alphabet
- At least 1 number
- Maximum length is 14 characters
- At least 1 lower case alphabet
- At least 1 of the following special characters !@#\$%^&*()[] Other special characters are not accepted.

Username: chantaiman123

Password: [masked]

Confirm Password: [masked]

Next

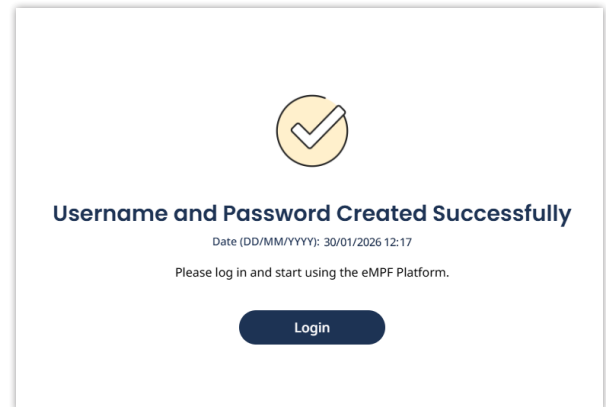

Tips: For casual employees participating in industry scheme, after successfully registering and logging into the **eMPF platform**, please check your Industry Scheme Casual Employee Card for use in future contribution processes and other instructions. Please select **"Profile Management"** under **"My Account"** on the menu bar, then select **"Casual Employee Card"**.

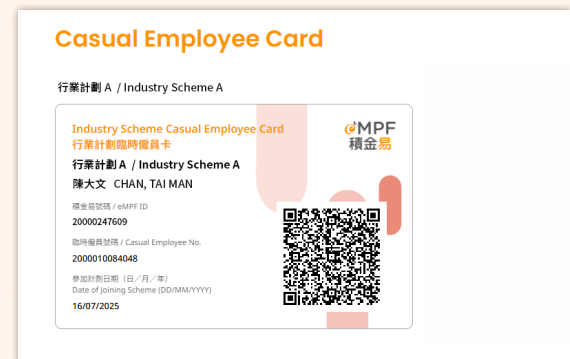
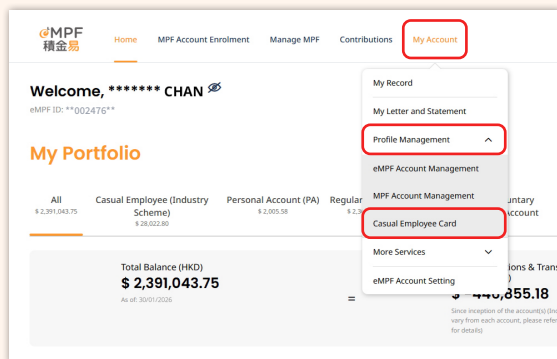

- End -